

VMK-SF 280-Winter VMK-SF 345-Winter VMK-SF 380-Winter

Chemical Mortar Cartridge styrene free for winter

For the anchoring in non-cracked concrete also for cold conditions in connection with Kalm threaded rods, galvanized, hot dip galvanized, stainless steel A4 and highly corrosion resistant 1.4529.

Areas of application

Stairway steps, monuments, Structural steelworks, well, window lattices, machines railings, fronts... in dry, moistening and aggressive damp environments, like chlorine, sea water or tunnels.

Characteristics

Chemical mortars are characterised by simple handling and ensure a straddling pressure free attachment with at the same time high load-carrying capacity. The application types of the mortars are versatile, thus are for the industrial and private use a multiplicity of application possibilities. The co-ordinated two-component mortar system VMK-SF allows an exact and simple dosage for the mortar mass.

Impact

The components, consisting of resin and hardener mixture, are in two separately arranged chambers. By using an injection gun both components are mixed in the nozzle to become a highly stress able mortar mass with high mechanical values.

Date 01.2009

Operating instruction:

- Drill the hole: Use a percussion drill.
- Cleaning of the drillhole:
twice in each case with the brush DBK
with the blowpump ABK and again with the brush
DBK.
*(with hollow blocks introduce the sleeve SHK).
- Insert the mortar cartridge into the injection gun APK.
Reject the first 10 cm strand or the first two strokes.
- Fill in the mortar from the drill-hole-deepest (sleeve-
deepest).
- Rotate the fixing element ASK, ASK-E or ASK-H
into the hole.
- Let the mortar harden (see reaction times).
- Fasten the element and tight the nut
(see Technical data)

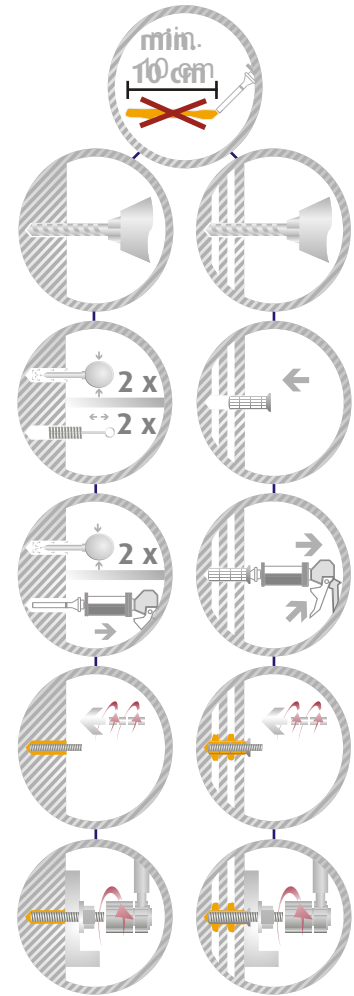

Reaction times:

Anchor base temperature [°C]		40	30	20	5	0	-5	-10	-15
Gelling time	[min]	1	2	3	5	12	20	30	40
Curing time	[min]	10	15	30	45	60	100	240	720

Technical Data:

**VMK guidelines for concrete $f_c=20 \text{ N/mm}^2$,
anchor stud quality 5.8**

		M8	M10	M12	M16	M20
Drilldepth	[mm]	80	90	110	125	170
Nominal drill hole diameter	[mm]	10	12	14	18	24
Design value for any load direction (including partial safety factor)	[kN]	3,6	6,4	11,6	13,9	18,5

Date 01.2009